

RoHS Compliant

Process Sealed Miniature Toggle

## Specifications

Electrical Ratings	.04mA @ 20VAC or VDC max
Electrical Life	40,000 cycles typical
Contact Resistance	≤100mΩ initial
Actuation Force	150 ± 50gF
Dielectric Strength	500Vrms min between contacts

Insulation Resistance	≥500MΩ min
Operating Temperature	-40°C to 85°C
Storage Temperature	-40°C to 85°C
Sealing Degree	IP67

## Materials

Actuator	6/6 Nylon, Glass Filled, Flame Retardant, Heat Stabilized, UL94V-0
Housing	6/6 Nylon, Glass Filled, Flame Retardant, Heat Stabilized, UL94V-0
Bracket	Steel, Tin Plated
Contacts	Copper Alloy, Gold over Nickel Plated
Terminals	Copper Alloy, Gold over Nickel Plated

## Ordering Information

1. Series	CST	1	1	T	2	C	R
CST							
2. Number of Poles							
1 = Single Pole							
2 = Double Pole							
3. Switch Function							
0 = Off-None- On							
1 = On-None-On							
3 = On-Off-On							
4. Actuator							
T = Standard toggle, 3.80mm							
5. Actuator Color							
2 = Black, standard							
6. Terminals							
C = PC pin							
H = Horizontal mount, right angle PC pin							
V = Vertical mount, right angle PC pin							
7. Contact Material							
R = Gold plated							

## Process Sealed Miniature Toggle

### Switch Function



**SPST NO**



FUNCTION	TOGGLE POSITION		
0	OFF	NONE	ON
TERMINALS	--	--	4-6

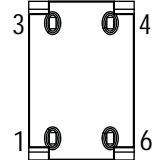
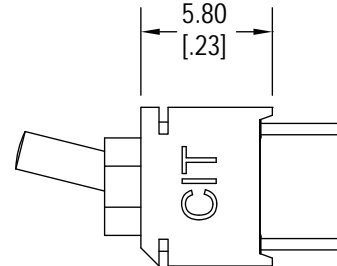
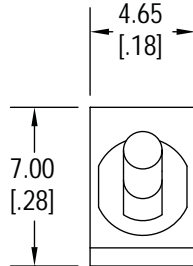

**SPDT**



FUNCTION	TOGGLE POSITION		
1	ON	NONE	ON
3	ON	OFF	ON
TERMINALS	5-6	--	5-4

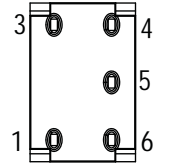
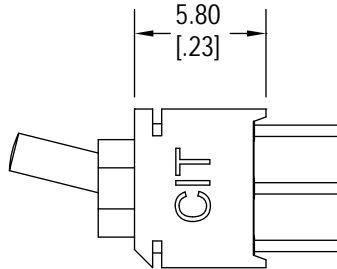
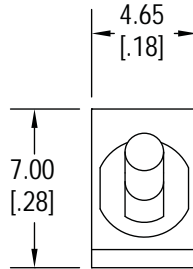

**DPST NO**

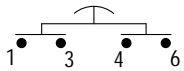

FUNCTION	TOGGLE POSITION		
0	OFF	NONE	ON
TERMINALS	--	--	1-3, 4-6

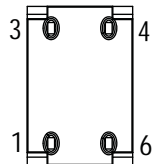
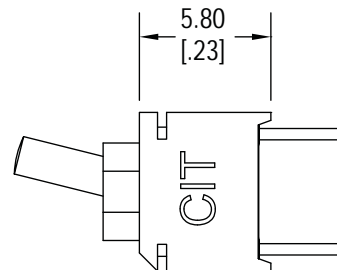
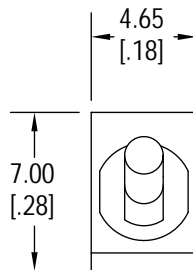

**DPDT**

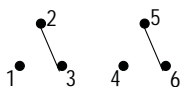

FUNCTION	TOGGLE POSITION		
1	ON	NONE	ON
3	ON	OFF	ON
TERMINALS	2-3, 5-6	--	2-1, 5-4

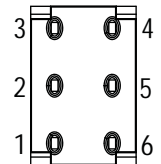
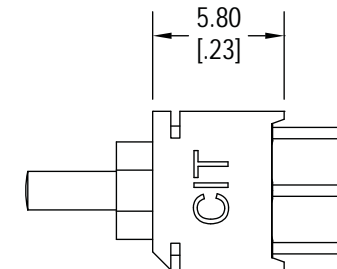
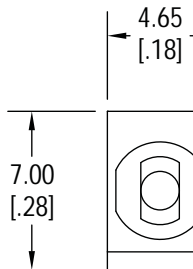

**Actuator**

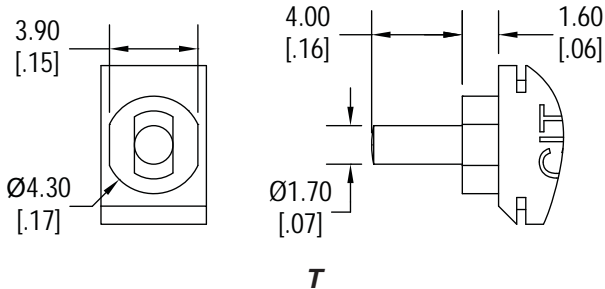

**Terminal Options**

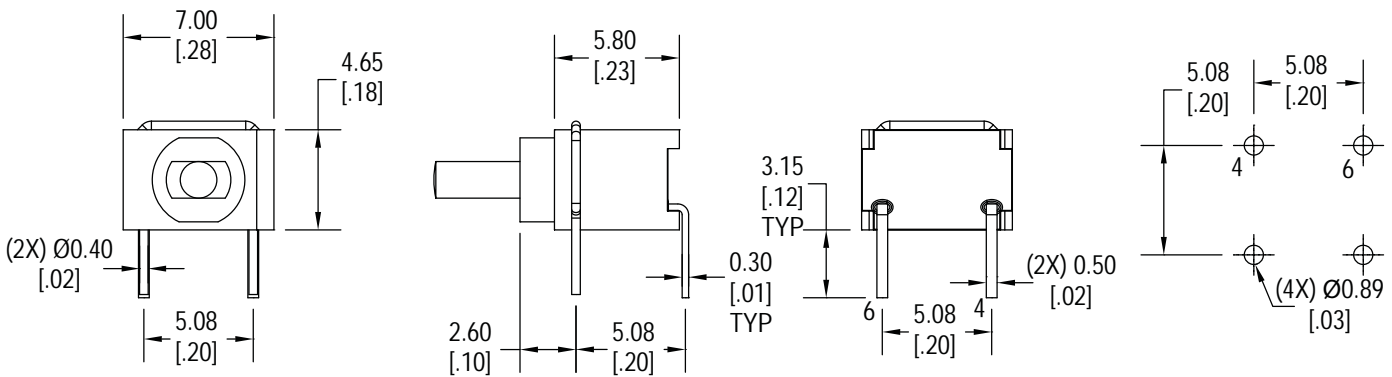
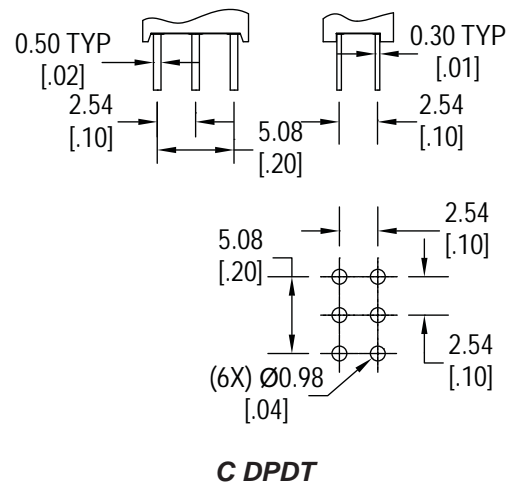
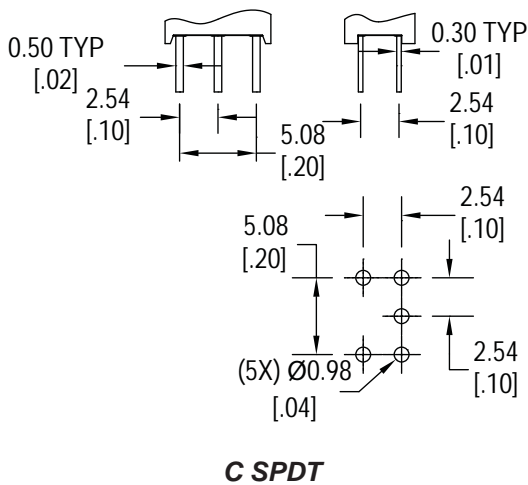

**H = Horizontal mount, right angle PC pins, SPST N.O.**

**Terminal Options**

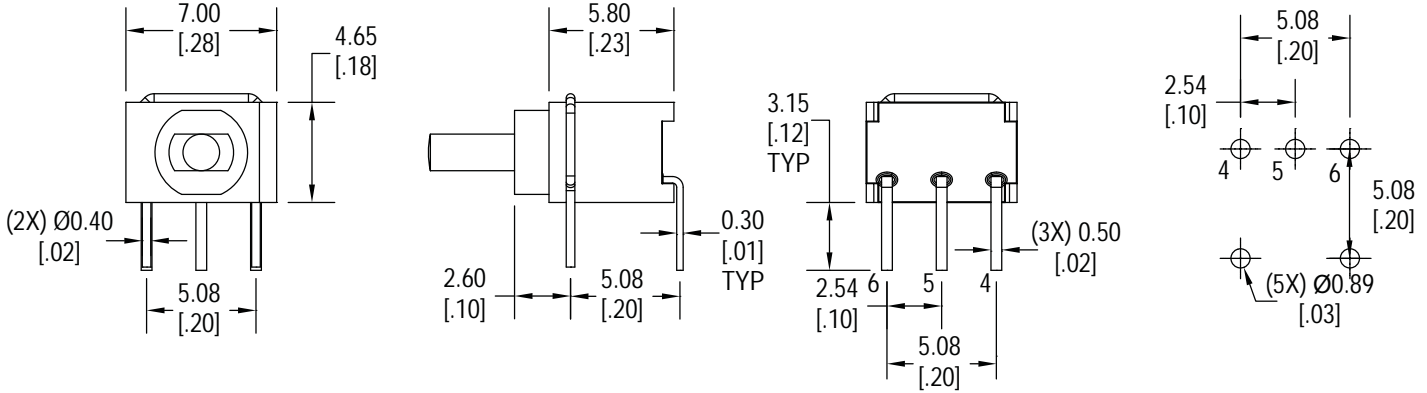

**H = Horizontal Mount, right angle PC pins, SPDT**

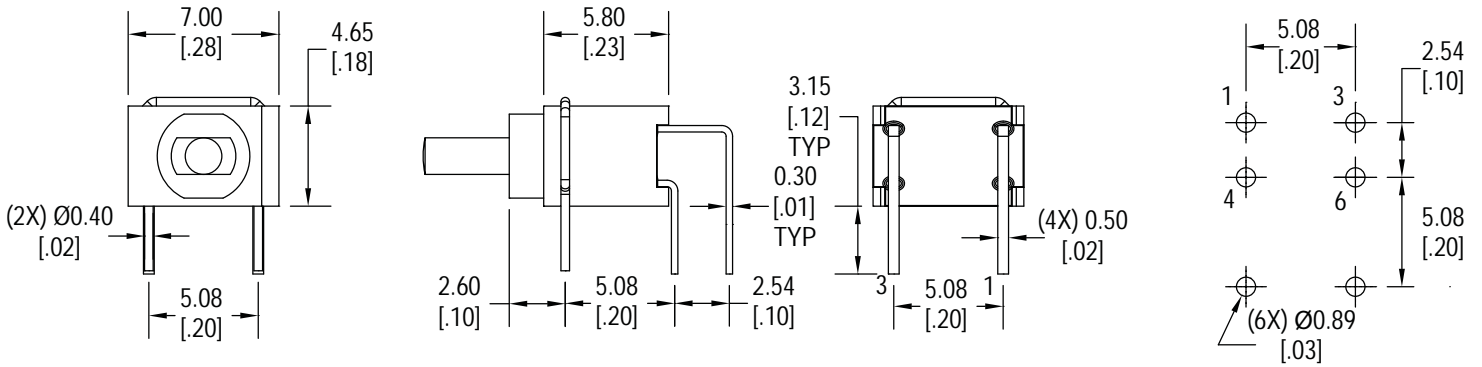

**H = Horizontal mount, right angle PC pins, DPST N.O.**

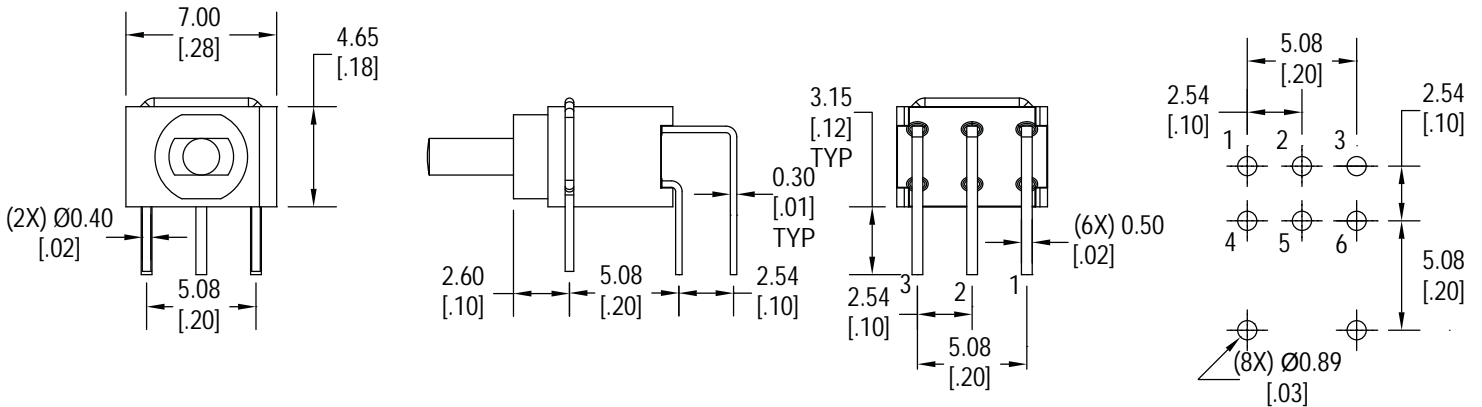

**H = Horizontal mount, right angle PC pins, DPDT**

**Terminal Options**

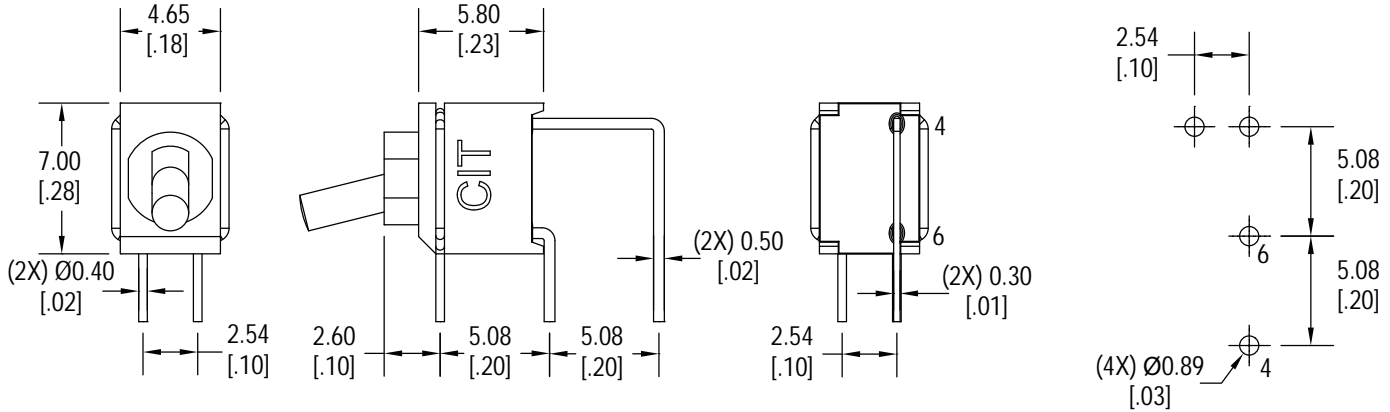

**V = Vertical mount, right angle PC pins, SPST N.O.**

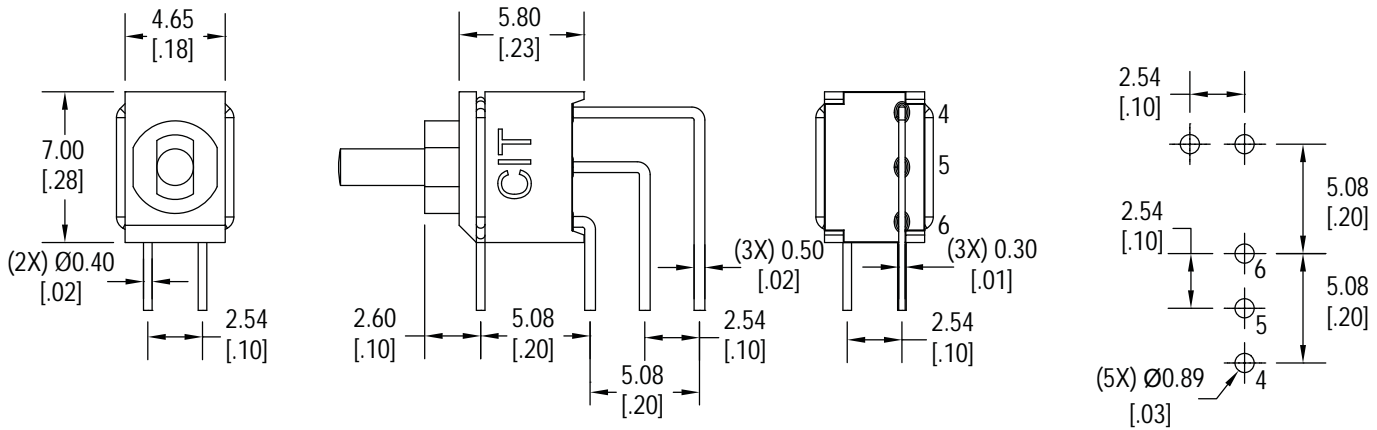

**V = Vertical Mount, right angle PC pins, SPDT**

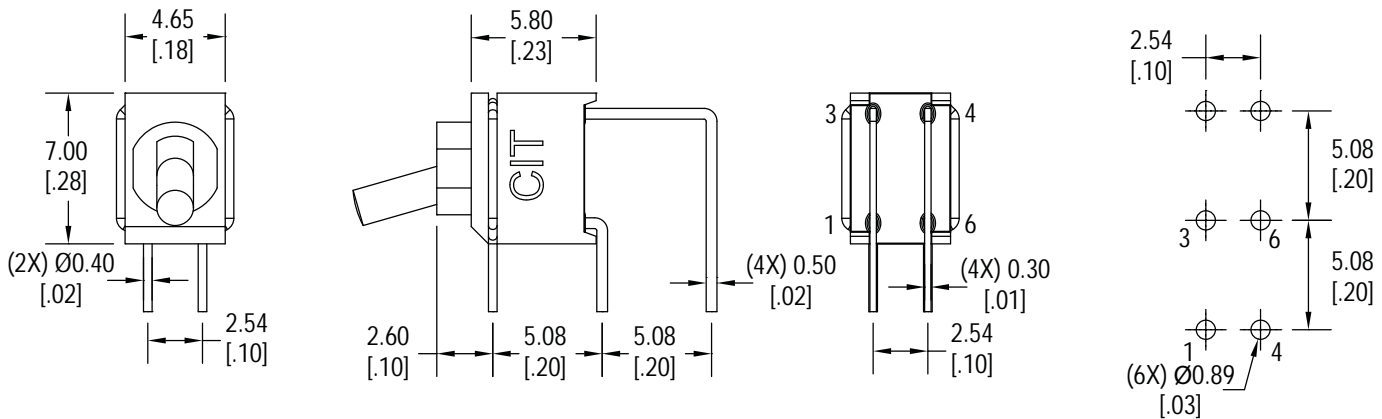

**V = Vertical mount, right angle PC pins, DPST N.O.**

## Terminal Options

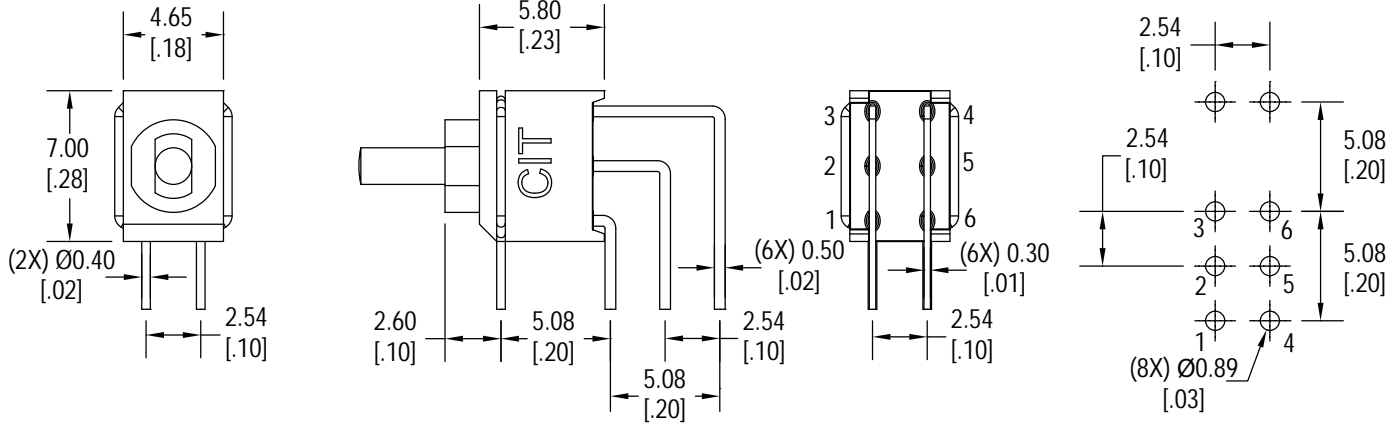

**V = Vertical mount, right angle PC pins, DPDT**